



Coos Watershed Association
P.O. Box 388
Coos Bay, OR 97420-0607
Phone: (541) 888-5922 x 305
e-mail: ecope@cooswatershed.org

Request for Bid

Structural & Electrical Improvements at the Matson Creek Wetland Preserve

The Coos Watershed Association (CoosWA) is requesting bids to conduct structural and electrical work on a garage at the Matson Creek Wetland Preserve, (95168 Tangent Ln) located five miles up Catching Slough Road in Coos Bay, OR. The project will include installing electricity throughout the garage, framing a wall, and installing garage doors (details listed below). A diagram of the structure is provided on page 4.

Schedule

Work must be **completed no later than September 10th, 2021**. There will be no possibility for an extension to be granted for this project, as its grant-supported funds are set to expire in September.

Bids must be received by CoosWA no later than **noon on Friday, July 9th**. The bid may be emailed in a single PDF document to ecope@cooswatershed.org or dropped off in person to the CoosWA office located at 300 Central Ave, Coos Bay OR 97420 between the hours of 8am and 12pm Monday-Thursday. Due to the ongoing COVID-19 outbreak, please notify us by phone or email if you intend to drop bids off in person. CoosWA is not responsible for illegible bids or bids that may be lost or delayed through e-mail.

Contractors may visit the project site prior to bidding. Please contact Ed Cope at 815-601-4665 to make a viewing appointment. Mistakes in the contractors bid that are a result of a contractor failing to visit the project site are the sole responsibility of the contractor. The successful bidder will be required to sign an agreement with the CoosWA prior to the start of work.

Bid

Please respond to this solicitation by returning the attached bid form (page 5). All primary and sub-contractors must be licensed in the State of Oregon and the CCB number must be identified on the bid form.

Evaluation for Award

Award will be made to the bidder whose quote is most advantageous to the CoosWA. Considerations include, but are not limited to: price, timeline, reputation of completing similar projects on time and on budget. **CoosWA reserves the right to refuse any and all bids, and to negotiate with the apparent bidder prior to signing contract.**



Insurance

Contractor must maintain insurance coverage during the contract period in the following amounts:

- Comprehensive general liability insurance with a combined single limit of not less than one million dollars (\$1,000,000) per occurrence and two million dollars (\$2,000,000) aggregate for bodily injury and property damage. Coverage must include commercial general liability; premises and operations; products and completed operations; contractual liability; and personal injury;
- Automotive liability insurance covering owned, hired and non-owned vehicles with a combined single limit of one million dollars (\$1,000,000) per occurrence;
- State or private industrial accident insurance covering contractor and all employees which shall fully comply with State and Federal Employment and Workers' Compensation laws;

A Certificate of Insurance, with an attached Additional Insured Endorsement naming the Coos Watershed Association, evidencing these coverage's must be on file in the CoosWA office prior to the commencement or the continuance of any work.

Payment

The Contractor must submit an all-inclusive invoice to CoosWA after the whole project is complete and has passed inspection. CoosWA will not submit payment until the project has passed inspection.

Termination of Contract

The CoosWA reserves the right to terminate the contract at any time if the quality of work is deemed inadequate or if the work is unlikely to be completed according to the work schedule and budget (see above).

Project Description

The contractor will be responsible for the work identified in the attached Scope of Work.

Permits

The contractor will be responsible for securing all necessary permits and scheduling and passing inspections.



Scope of Work

The Contractor shall:

- Install electrical wiring throughout the garage structure, as well as outlets (10), lights (6), and garage door lifts (2).
- Frame an exterior wall (~54' x 10'), then install two garage doors (with powered lifts) and one entry door (steel) in that wall.
- Purchase additional materials as necessary which are not included in the attached materials list.
- Acquire all necessary permits and pass inspection.

CoosWA will:

- Make select lumber available for contractor use (see list below).
- Provide 24-hour access to job site during construction window. Contractor's must follow county noise ordinances.
- Ensure timely payment of invoices submitted to CoosWA once the project has passed inspection.

CoosWA Lumber Inventory

- 2"x12"x12' (5)
- 2"x6"x10' (11)
- 2"x6"x12' (10)
- 2"x4"x16' (5)
- 2"x6"x16', pressure treated (6)
- 2"x6"x14', pressure treated (1)
- 1"x6"x20', primed white wood (3)
- 1"x4"x10', primed white wood (2)
- 1"x4"x5', primed white wood (6)
- 4"x4"x8' (4)
- 2"x6"x20', pressure treated (1)
- 4"x4"x10' (4)
- 4"x4"x12' (2)

Project Diagram

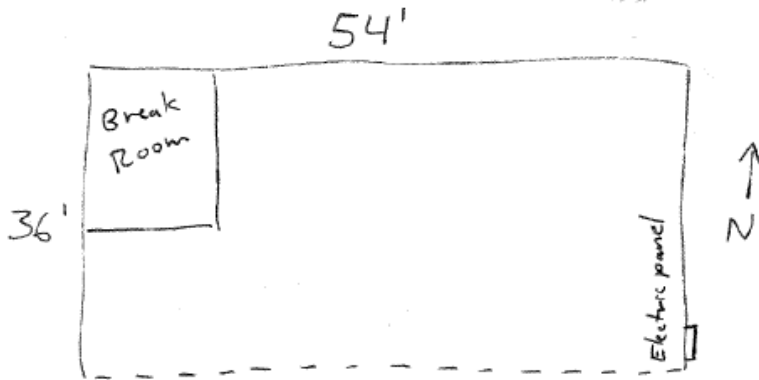

- 3 existing walls
- Contractor will frame 4th wall (south side)
- Install 2 garage doors + 1 man door in new wall
- Contractor will wire entire structure, including lights + outlets
- Break room to be equipped with 240v outlets



Bid Form

Structural Repairs at Matson Creek Wetland Preserve

Contractor Name & CCB #: _____

Contractor Address: _____

Contractor Phone: _____ Contractor E-Mail: _____

Bid amount:

<u>Electrical Total</u>	<u>Wall + Garage Doors Total</u>	<u>TOTAL Bid Amount</u>

Proposed Start Date: _____

Proposed Completion Date: _____

Contractor Signature and Date _____

Please include the following information for 3 references

Name and contact information	Project name	Completion date